

PLAN PARTER

CASA 110 mp
 S utila Parter= 55.71 mp
 S utila Etaj= 53.75 mp
 S utila totala = 109.76
 S construita = 73.18

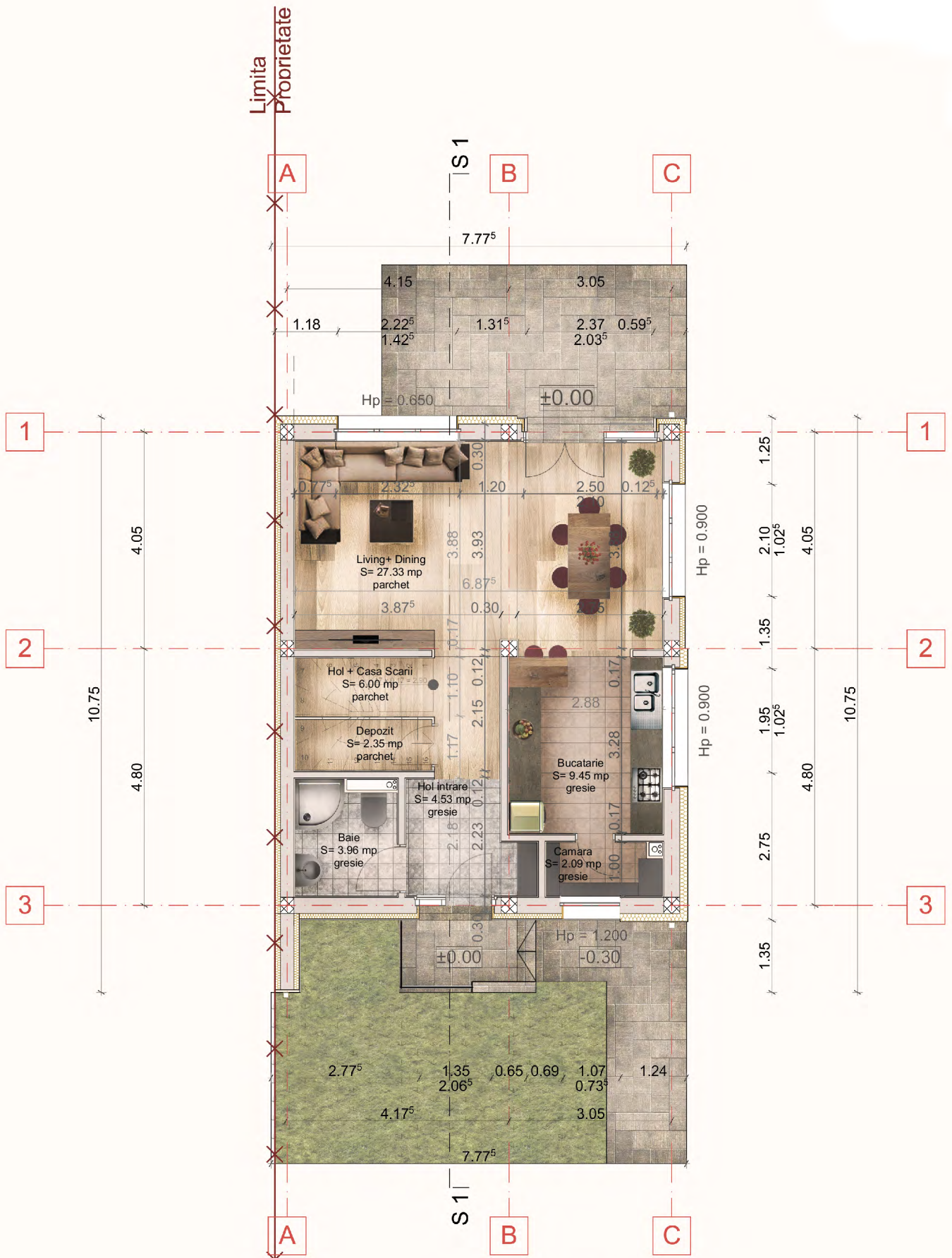

PLAN PARTER

CASA 110 mp
 S utila Parter= 55.71 mp
 S utila Etaj= 53.75 mp
 S utila totala = 109.76
 S construita = 73.18

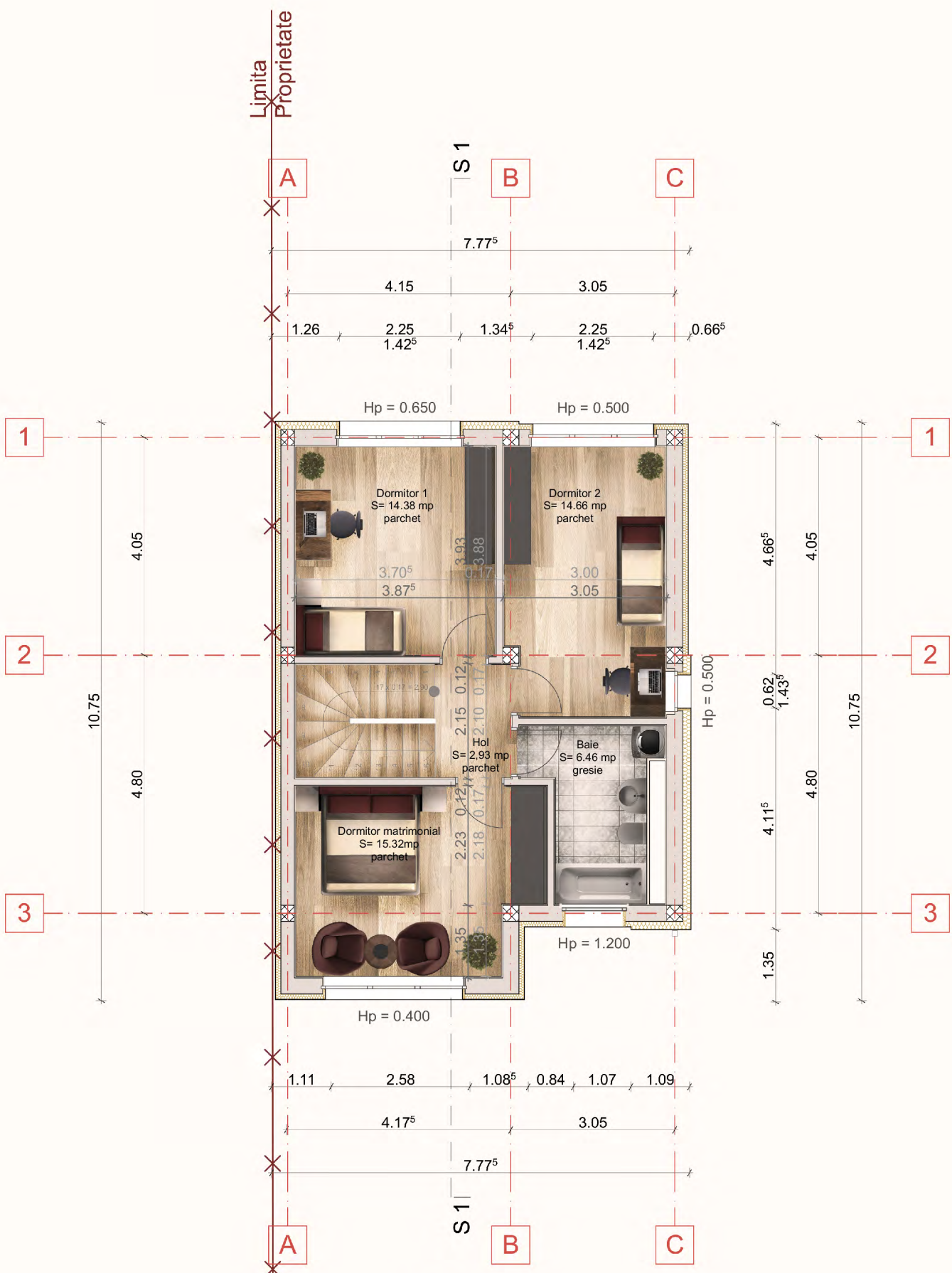

PLAN ETAJ

CASA 110 mp
 S utila Parter= 55.71 mp
 S utila Etaj= 53.75 mp
 S utila totala = 109.76
 S construita = 73.18